

## STCS60-SERIES

Stainless Precision Linear Stage, 0.5" Travel Series, stainless steel. The centre of the table has an M16 threaded hole with an array of M6 threaded holes – with which, most Optical components can be combined. In addition is the resolution of 10um spiral side micro-drive, which can also be installed outside the precision screw and the resolution of 5um spiral side micro-head.

ITEM	PLATFORM SIZE	ACTUATORS	AXES OF TRAVEL	TRAVEL	ROTATION CENTRE HEIGHT	WEIGHT
STCS60X-05						
STCS60X-05A						
STCS60X-05P						
STCS60XY-05						
STCS60XY-05A						
STCS60XY-05P						
STCS60XYZ-05						
STCS60XYZ-05A						
STCS60XYZ-05P						

### STCS60X-05

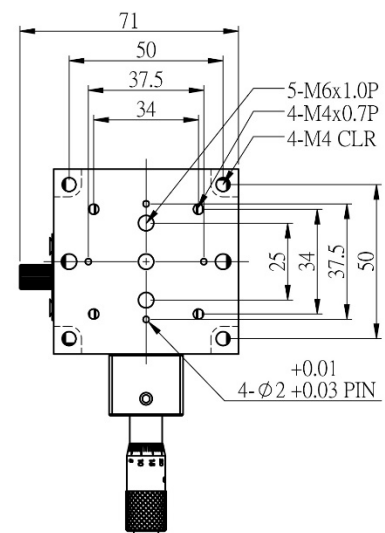
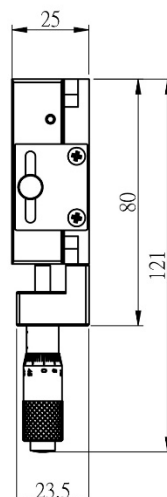
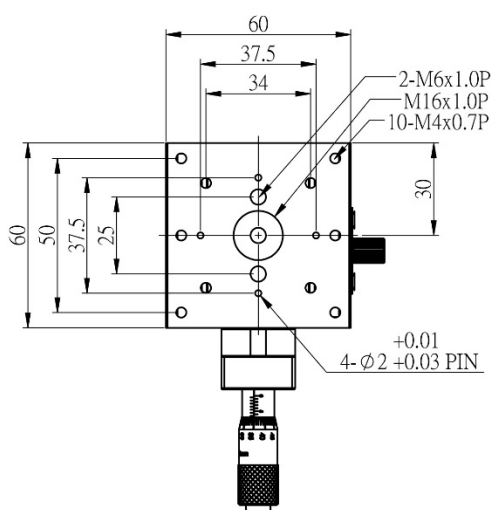
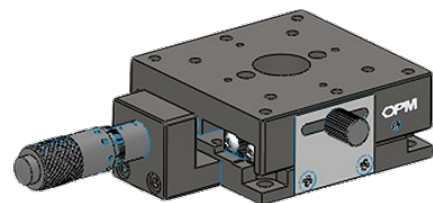

## STCS60X-05A

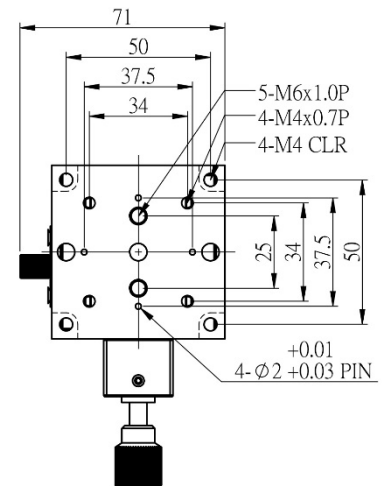
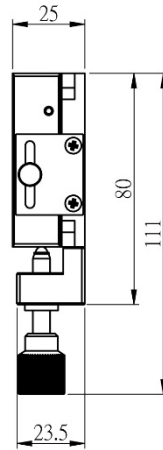
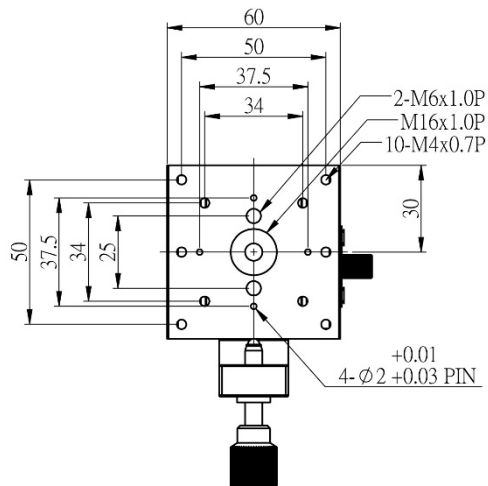
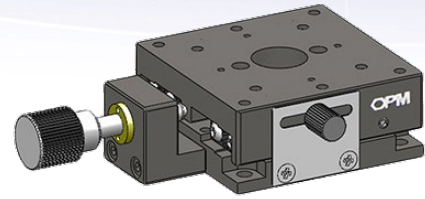

## STCS60X-05P

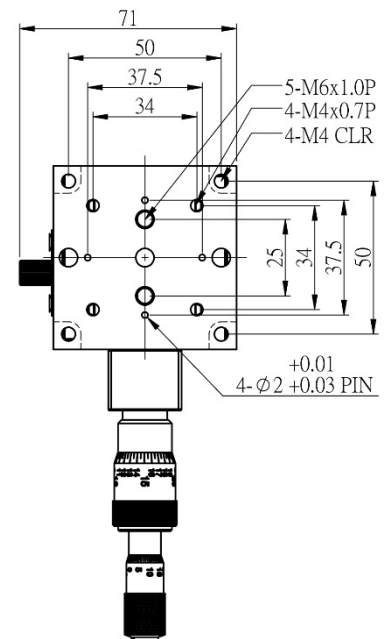
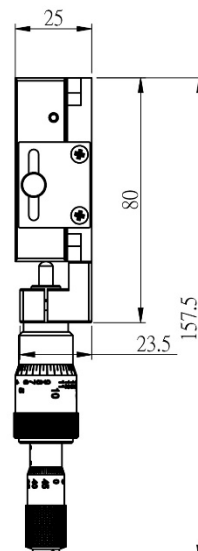
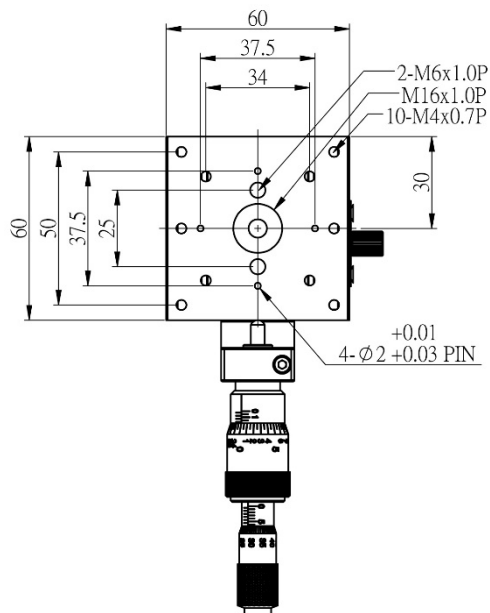
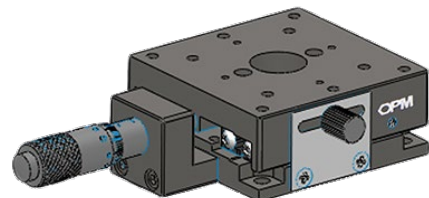

## STCS60XY-05

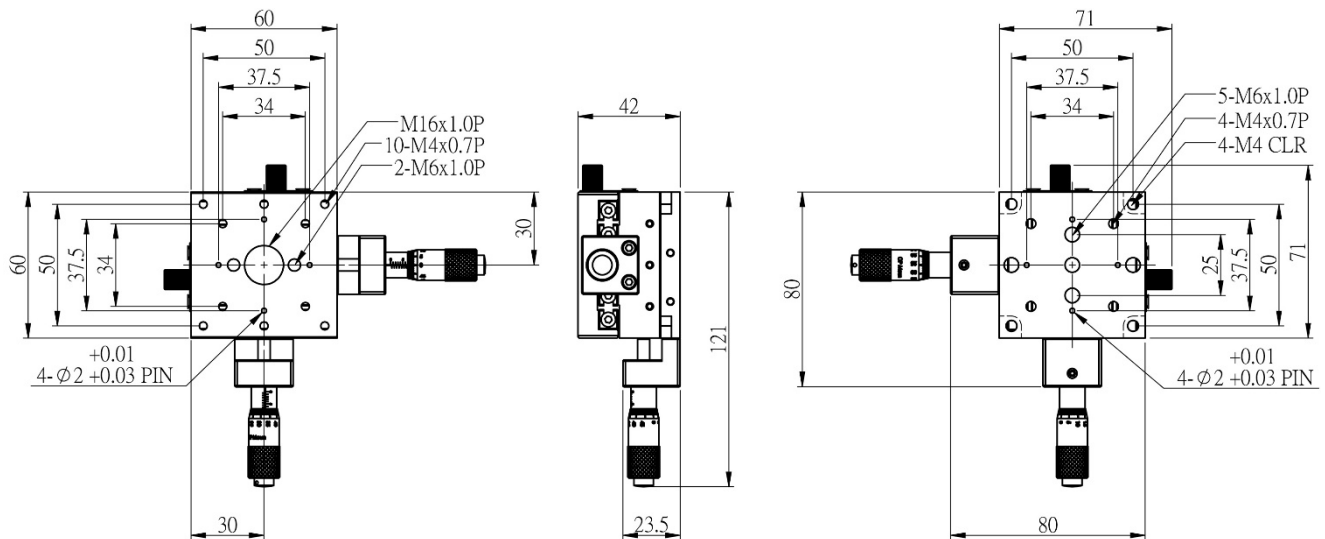
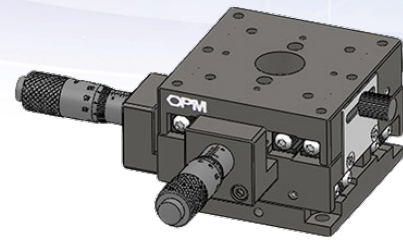

## STCS60XY-05A

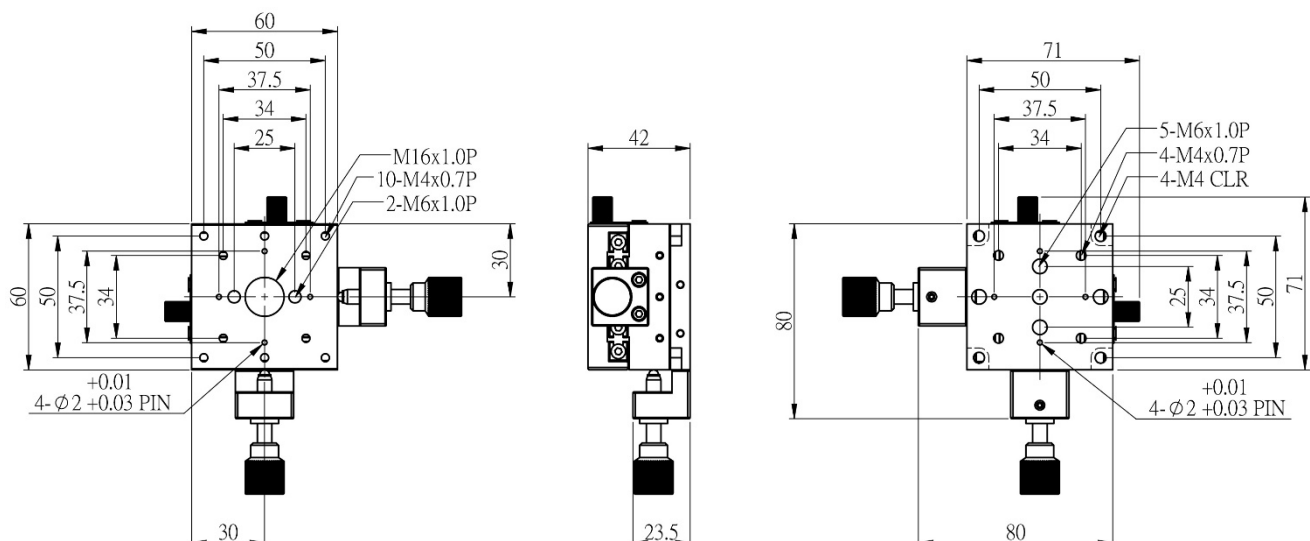
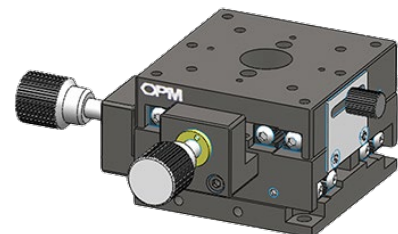

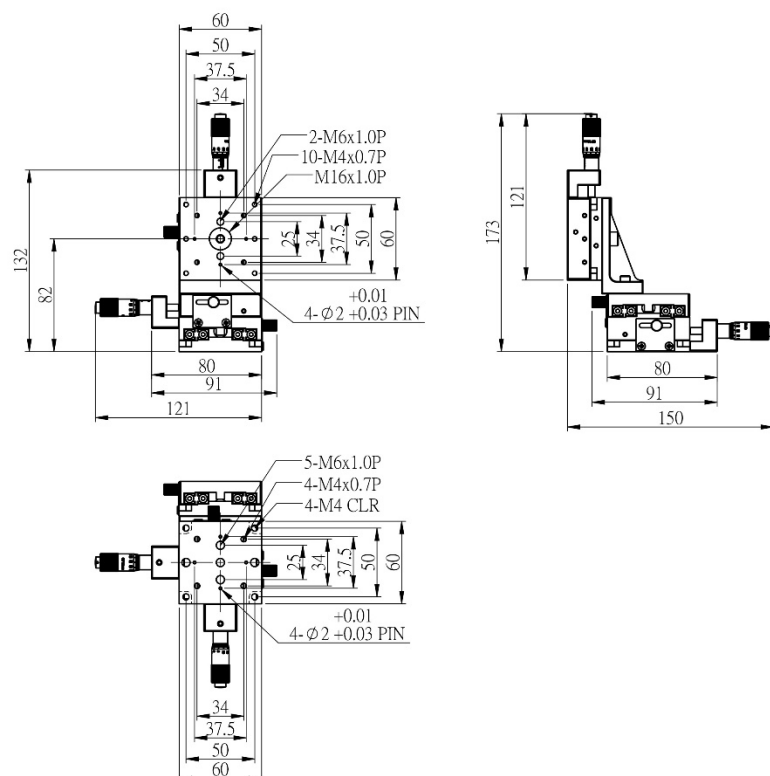
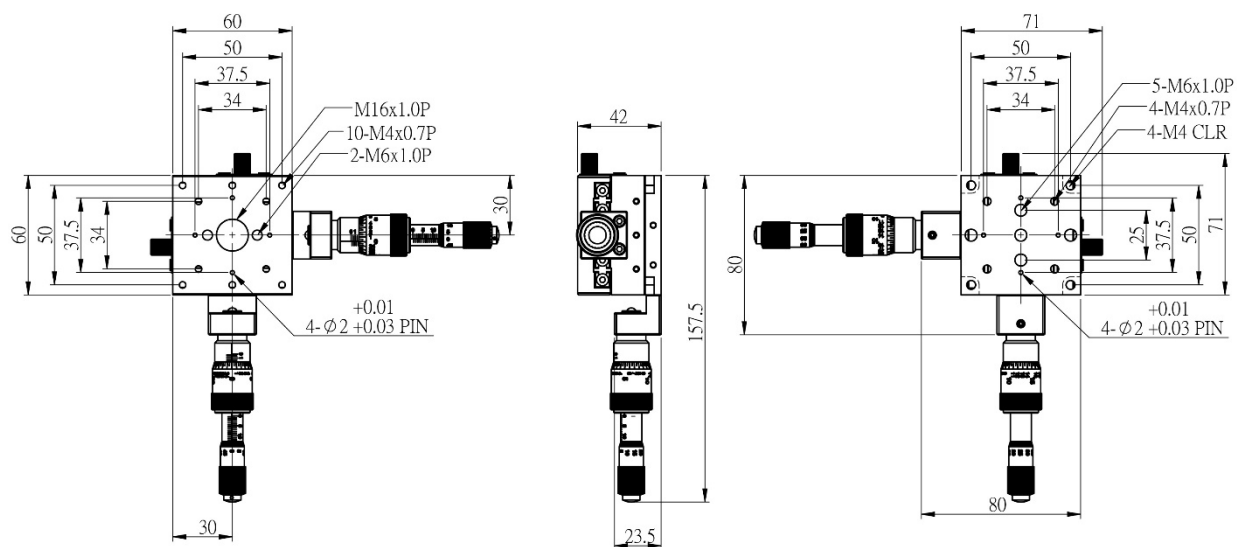

[illegible]

## STCS60XYZ-05A

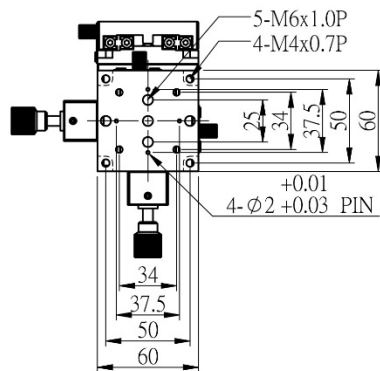
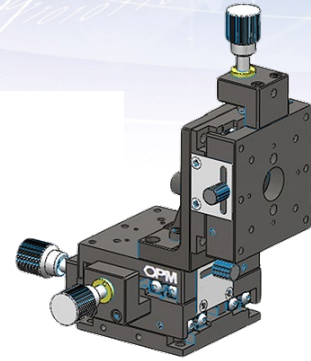
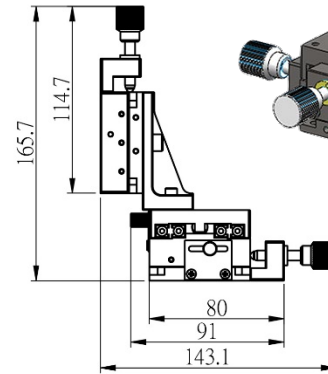
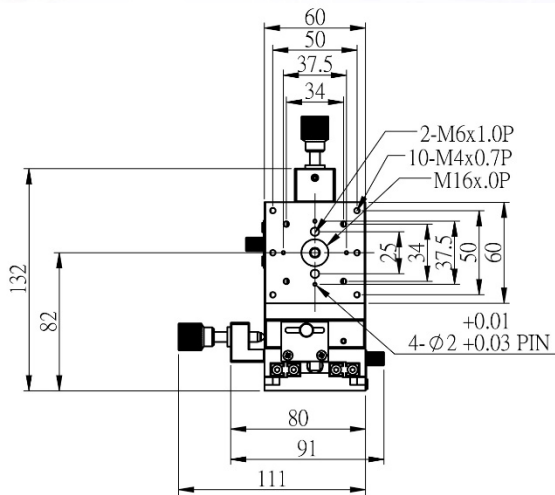

## STCS60XYZ-05P

