

## TS65-1 SERIES

Standard Linear Stage, 1" Travel Series with crossed roller guide. These Stages provide 25mm of linear translation with less than 165 $\mu$ rad of deviation per axis in pitch and yaw over the full range of stages. Constructed with a full aluminium body, it is suitable for high load capacity and precise motion and has thirteen M6 and four M4 tapped holes to combined with other mechanisms. An M4 locking structure is provided on the side of each TS65-1 to lock the platform.

Note: If need a higher precision product please look at the TSS65 Series.

ITEM	PLATFORM SIZE	ACTUATORS	AXIS	TRAVEL	STRAIGHTNESS	PARALLELISM	RESOLUTION	LOAD
TS65X-1	60x60mm	Micrometer	X	25mm	30 $\mu$ m	30 $\mu$ m	10 $\mu$ m	0.4kg
TS65X-1A	60x60mm	100 TPI	X	25mm	30 $\mu$ m	30 $\mu$ m	NA	0.4kg
TS65XY-1	65x65mm	Micrometer	XY	25mm	30 $\mu$ m	100 $\mu$ m	10 $\mu$ m	0.8kg
TS65XY-1A	65x65mm	100 TPI	XY	25mm	30 $\mu$ m	100 $\mu$ m	NA	0.8kg

### TS65X-1

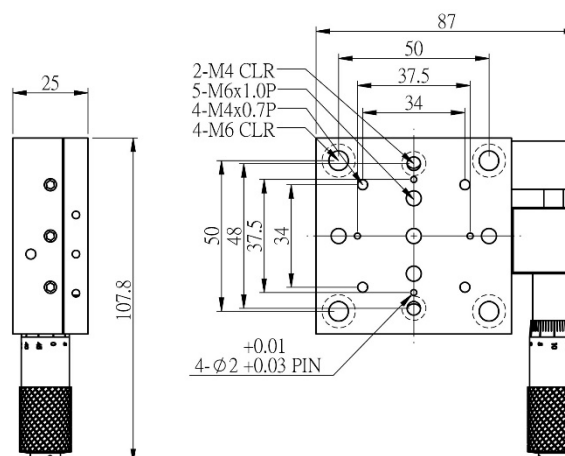
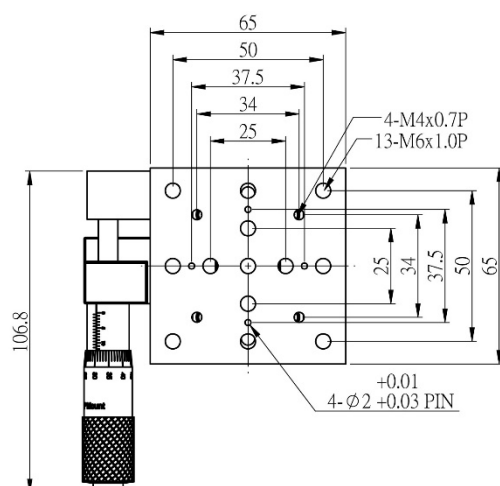

## TS65X-1A

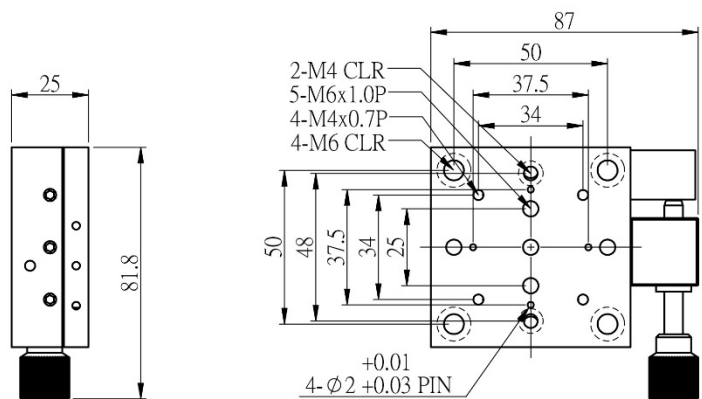
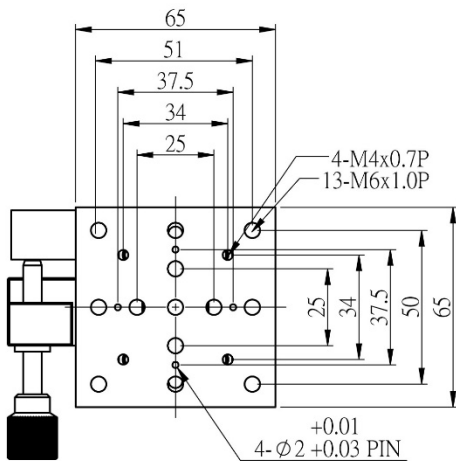

## TS65XY-1

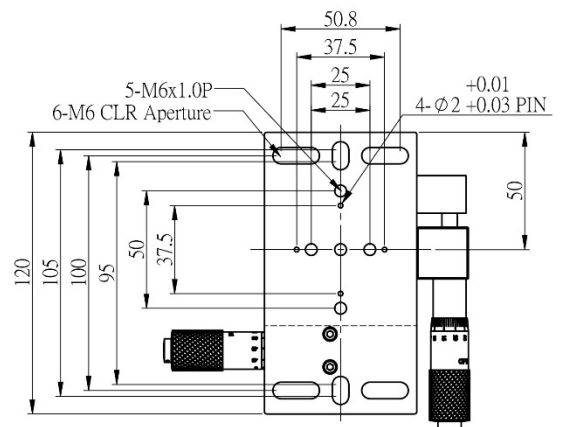
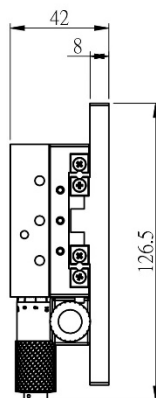
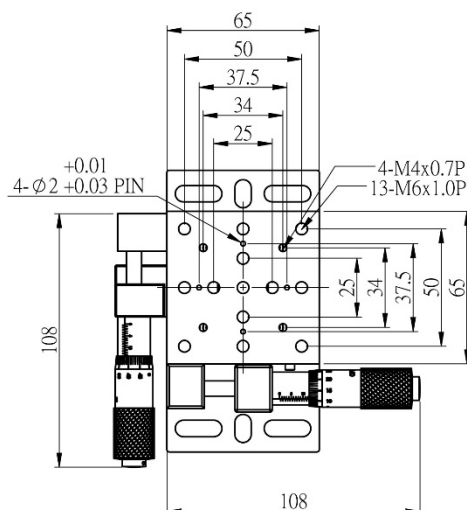

# TS65XY-1A

